

### How to operate the Overhead Projector

#### © Overview

Every general purpose classroom is equipped with a overhead projector for displaying transparencies.



#### © To use the OHP

##### Changing the Lamp :

- Press the power button to turn ON the lamp and direct image to the screen.
- Place transparency on glass plate and adjust focus using the knob on the lens column.
- The overhead projector contains two lamps. If the primary lamp fails, switch to the alternate lamp using the lamp changeover lever.

##### Color tuning dial :

Some OHP models have a color tuning dial. This will eliminate blue or brown corners if seen on the screen.

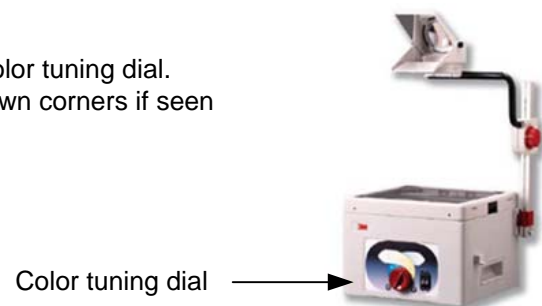

##### For assistance :

Assistance is available by calling 59666 Opt1 and ask for AV assistance.

##### Training :

Training on equipment in rooms can be arranged at any time.  
Call Space Services Help Desk Phone: 612 55909